



**MIDWEST
CUSTOM
SOLUTIONS**
PRECISION QUALITY INTEGRITY



AIR HANDLING & STORAGE
P R O D U C T L I N E



**"MADE IN AMERICA" REAWAKENED
FORGED IN THE CRUCIBLE OF LIBERTY
POWERED BY THE FUEL OF FREEDOM**

REV. 0.0 07282023



VOLUME YOU NEED.
QUALITY YOU WANT.

XF Series

HIGH EFFICIENCY FANS

Our XF Series High Efficiency Centrifugal Fans are precision engineered, built, balanced and finished to provide you with maximum service life while moving air in your most demanding operational conditions.

At Midwest Custom Solutions, we know you expect to get the most from your equipment investment dollars. It's for this reason we refuse to compromise on material selections, manufacturing processes or finishing standards. We know how much you depend on your equipment... providing a long-lasting, worry-free product investment is our primary goal.

- ❖ Serviceable Bearings
- ❖ AR 235 Construction Standard
- ❖ Precision Balanced Rotors
- ❖ Optional Fan Rotation Direction
- ❖ Precision Machined Rotor Shafts
- ❖ Optional Material Selections
- ❖ Industry-Leading Finishes



"MADE IN AMERICA" REAWAKENED
FORGED IN THE CRUCIBLE OF LIBERTY
POWERED BY THE FUEL OF FREEDOM

VOLUME YOU NEED. QUALITY YOU WANT.

Your high expectations of the equipment you invest in are why we install only industry-leading serviceable bearings on all of our fans for a smooth-running means of air movement coupled with countless hours of worry-free run time.

Our XF Series fan rotors are constructed from Abrasion Resistant AR235 material standard, incorporating engineered designs and strict manufacturing practices to ensure this critical component is able to safely withstand the rigors of your most demanding operational environments. MCS is also able to provide rotors manufactured in T1A, AR235, AR400, AR500, 304SS, 316SS and Hardox or as specified by the client.

We also ensure that each and every one of our fan rotors is precision balanced for vibration-free, quiet performance and years of service in your most demanding operational environments. Vibration-free operation also means less operational stress placed on support structures and adjacent equipment.

Each of our fans is offered with optional fan rotation direction and discharge orientation. We know that not all equipment performance requirements will be the same, so be sure to speak with our sales team to ensure we make your installation care-free.

Rotor shafts are precision-machined to exacting specs with durability and safety as prime considerations. Rugged and stout belt shrouds are also engineered to provide maximum operational safety for those who work within the equipment's proximity.

All MCS fans are built from quality materials and assembled by skilled technicians. Frames are offered with mild steel construction standard, however, we also provide for a materials selection with specific fan applications or installations in mind.

As with all of the products manufactured at Midwest Custom Solutions, our fans are finely finished with high-quality, industry-leading paints, coatings and sealing products.

We diligently strive to build value into every facet of our products, ensuring all of our equipment provides the longest-lasting, greatest value for your investment dollars.

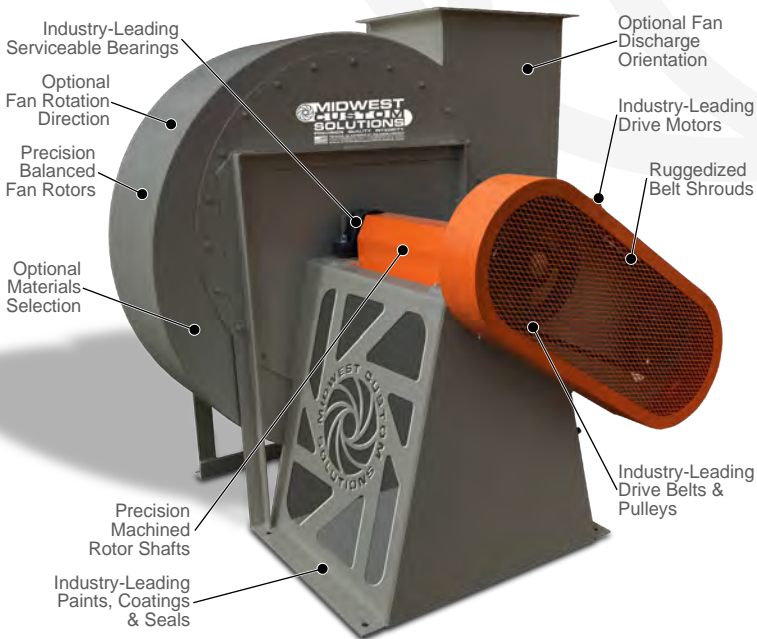
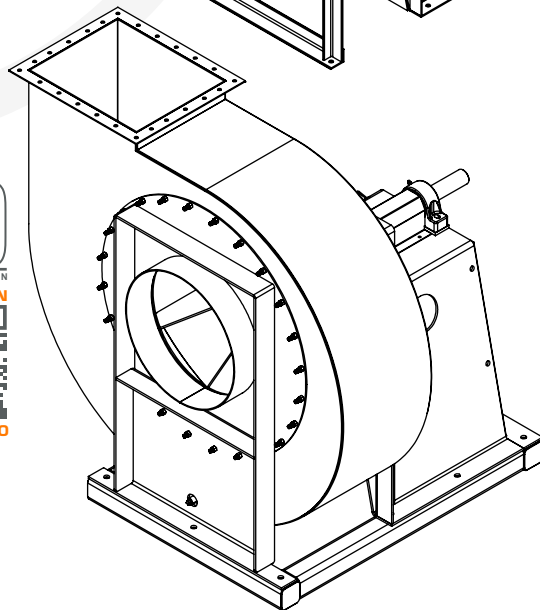
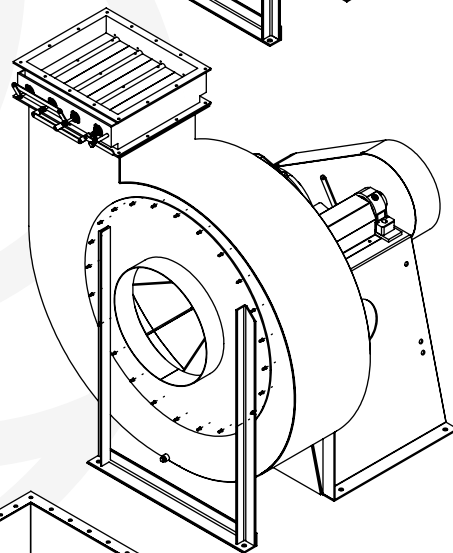
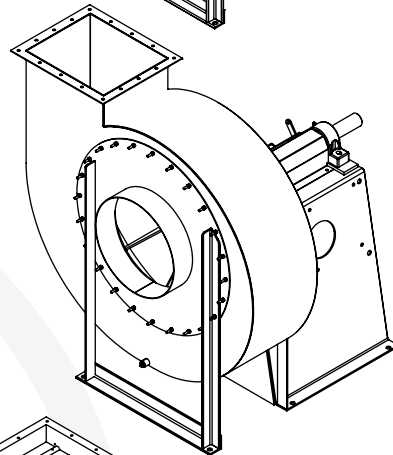
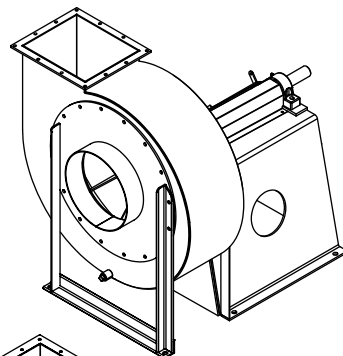



**PARTICLE SEPARATION
AT ITS VERY FINEST.**

HE Series

CYCLONES

Although there are no actual moving parts in the HE Series Cyclones from Midwest Custom Solutions, we remain steadfast in providing the same attention to detail and quality for each one that leaves our facilities as those products which are far more complex in design and operation.

As with all of our products, we've designed and engineered our HE Series Cyclones with same strength, durability, efficiency and longevity you've come to expect from each and every product manufactured by MCS. We build your equipment as though it were being installed and used in our own facilities.

With this lofty goal in mind, we've selected only the highest quality materials for our HE Series of Cyclones. Our highly skilled fabrication technicians have years of experience in their craft and know how to do things "the right way." You can see their craftsmanship in each and every piece of equipment which leaves the MCS facilities.



"MADE IN AMERICA" REAWAKENED
FORGED IN THE CRUCIBLE OF LIBERTY
POWERED BY THE FUEL OF FREEDOM

PARTICLE SEPARATION AT ITS VERY FINEST.

All frame and support structures are built for rugged, continuous, and thorough material processing. Structural framing and cross-supports are all thoughtfully and strategically engineered with ease of access, safety and durability in mind.

Cyclone processing air rotation may be specified by our clients in a clockwise or counterclockwise direction. Inlet and outlet ducting will be manufactured to direct airflow as required to suit your unique operational needs. We also provide for a materials selection with specific Cyclone applications or installations in mind, whether is be in the food, mineral, chemical or agricultural processing industries.

Access Panels for clean-out and interior inspection of expansion chambers come standard in all of the HE Cyclones from Midwest Custom Solutions. Mounting brackets and foot pads are meticulously installed by our technicians who know the importance of proper equipment installation on your site.

All rounded components are precision rolled and continuously welded. Only high-quality fasteners are used in assembly to ensure durability, withstand vibration and provide longevity of use in the field.

As with all of the products manufactured at Midwest Custom Solutions, our HE Series Cyclones are finely finished with high-quality, industry-leading paints, coatings and sealing products. We diligently strive to build value into every facet of our products, ensuring all of our equipment provides the longest-lasting, greatest value for your investment dollars.

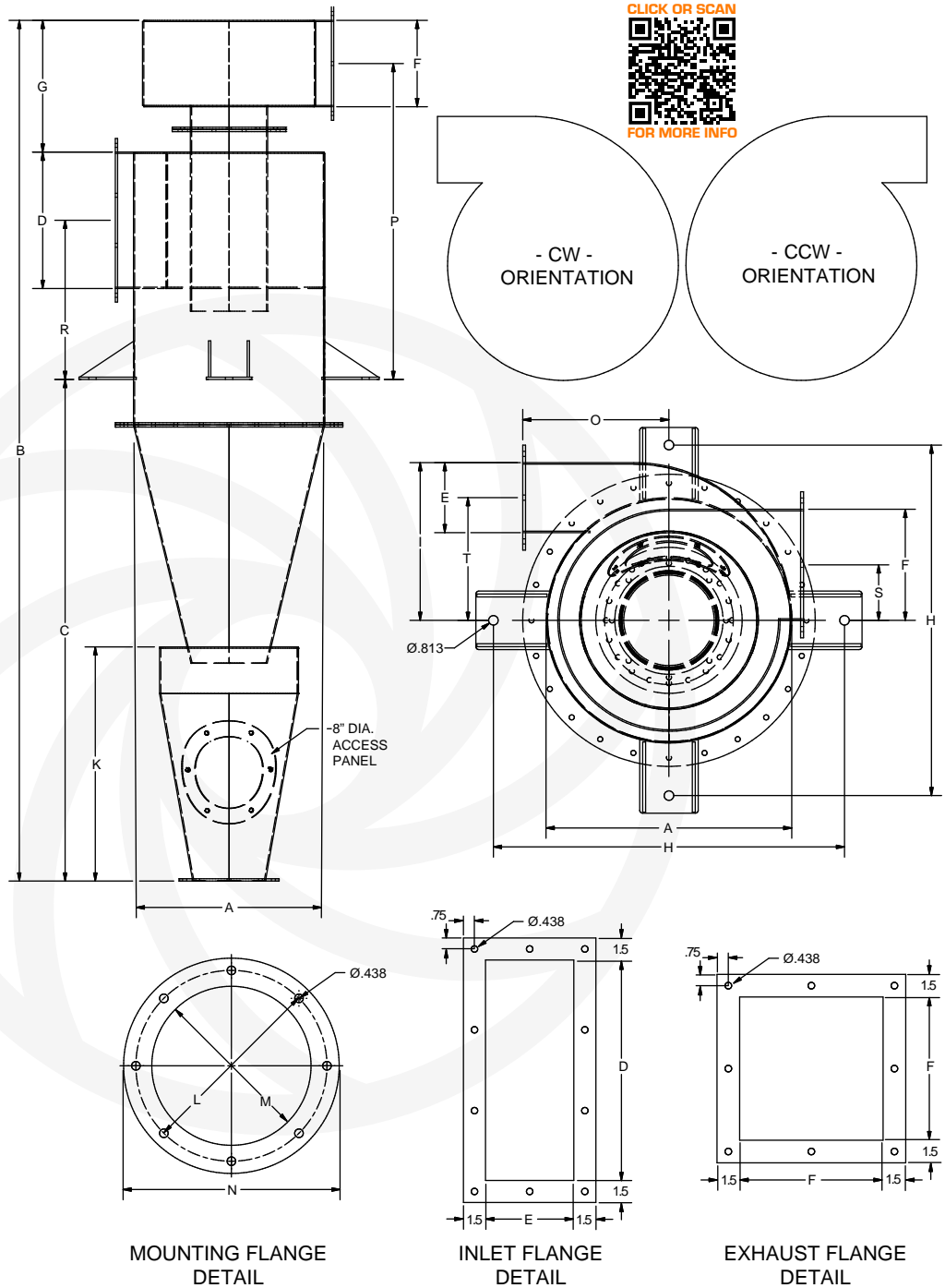

SERIES	VOLUME/CFM			WEIGHT (in lbs.)	DIMENSIONS (in inches)																		
	MIN	OPT	MAX		A	B	C	D	E	F	G	H	I	J	K	L	M	N	O	P	R	S	T
HE-21	2,150	2,325	2,500	~325	21	94.69	55.19	15	6	9.5	14.5	30	13.5	19	25.75	9.5	8	11	12.5	34.75	17.5	4.75	10.5
HE-24	2,525	2,875	3,250	~425	24	108.56	61.81	18	6.5	10.75	15.75	33	15.38	21.5	25.75	9.5	8	11	14	41.38	22	5.38	12.13
HE-27	3,275	3,650	4,025	~550	27	120.5	68.5	20	7.25	12	17	36	17.13	24	37.63	11.75	10	13	15.5	46	25	6	13.5
HE-30	4,050	4,475	4,900	~625	30	132.38	75.13	22	8	13.25	18.25	39	19	26.5	37.63	11.75	10	13	17	50.63	28	6.63	15
HE-33	4,925	5,525	6,150	~750	33	144.69	81.69	24	9.25	15	20	42	20.63	30	37.63	11.75	10	13	18.5	55.5	31	7.5	16
HE-36	6,175	6,875	7,600	~850	36	153.63	86.13	25.5	10.75	16.50	21.5	45	23.38	33	37.63	11.75	10	13	20	59.25	33.25	8.25	18
HE-39	7,625	8,225	8,800	~1,025	39	174.19	102.44	27	11.75	17.75	22.75	48	25.38	35.5	49.44	11.75	10	13	21.5	62.88	35.5	8.88	19.5
HE-43	8,825	9,800	10,800	~1,200	43	188.75	109	30	13	19.75	24.75	52	27.75	39.5	49.44	11.75	10	13	23.5	69.88	40	9.88	21.25
HE-47	10,825	11,700	12,600	~1,400	47	202.94	115.69	33	13.75	21.25	26.25	56	30.38	42.5	49.44	11.75	10	13	25.5	76.63	44.5	10.63	23.5



Phone: 316.282.9999
 Email: sales@midwestcustomsolutions.com
 Web: www.midwestcustomsolutions.com
 REV. 0.1 02012022



"MADE IN AMERICA" REAWAKENED
 FORGED IN THE CRUCIBLE OF LIBERTY
 POWERED BY THE FUEL OF FREEDOM

XF SERIES HIGH EFFICIENCY FANS



HE SERIES HIGH EFFICIENCY CYCLONES



HIGH CAPACITY STORAGE BINS



PARTICULATE COLLECTION HOOD



"MADE IN AMERICA" REAWAKENED

Your Most Trusted Partner in Industrial Dehydration.

Our mission is to apply proven solutions to the complex issues which you experience in your daily operations.

The industry in which you conduct business is quite complex and you need a trusted partner to ensure your operations are profitable with consistent, precise and predictable equipment performance. Midwest Custom Solutions is here to take the worry out of your mass production dehydration requirements with our proven solutions, years of industry experience and resolute integrity to keep your interests first and foremost.

Our Technical Team will develop a custom plan for your specific dehydration and drying requirements.

Listening to your precise operational requirements and business objectives to ensure we thoroughly understand your specific product parameters is our first goal. We then develop exacting engineered solutions to establish your profitability the moment your equipment is completed with the highest overall efficiencies, lowest product loss and the most outstanding financial returns on your initial equipment investment.

MCS Team Members possess decades of extraordinarily specialized professional experience.

Our Technical Team will develop a custom plan for your specific dehydration equipment requirements, air handling demands, material sorting and delivery concerns, cooling needs, and particle separation essentials. We are unwaveringly dedicated and purposefully determined to "design your industrial dehydration equipment better than anyone else in our industry" - that is our personal commitment to your professional success.

Our "WHY"

We diligently strive to make all we interact with on a daily basis better through thoughtful implementation of innovative design, attention to detail for improved efficiencies, and studied practices for increased profitability with decreased expenses for our customers and clients.

Sound like a lofty business endeavor? It is. However, we're up to the challenge and look forward to serving our clients, customers, and industry with equipment, products and service which proves such a bold statement true.

Our "VISION"

We endeavor to design and manufacture innovative, quality, precision equipment which positively impacts our customers and clients, our community, our industry, our country, and our world.

There is an old axiom which states: "It isn't bragging if you can do it." We fully intend to honor this truism understanding the impact our products and equipment have on our industry and your bottom-line. The responsibility is not one we take lightly and we will continually aspire to fulfill your highest expectations.

Our "VALUES" PRECISION...

... because you **NEED** it for timely equipment installs, improved operational efficiencies, and increased profits in your business practices. We know you expect **PRECISION** from your equipment suppliers, machinery acquisitions, and gear selections.

QUALITY...

... because you **WANT** your equipment expenditures to last over time with worry-free operation and limited down-time in costly maintenance. We know you expect **QUALITY** when investing in equipment for your business and operating processes.

INTEGRITY...

... because you **ENJOY** sporting this personal trait yourself and appreciate your interactions with business partners who exemplify a high degree of honor and respect in their daily practices. We know you expect **INTEGRITY** in your daily business relationships where trust is pivotal to your profitable operations.

We invite you to visit our website to witness first-hand how we are steadfast in our focus to the "Reawakening of 'Made in America.'" Our Team Members eagerly await the opportunity to help you conquer the most worrisome processing obstacles in your daily business and operating practices - we look forward to speaking with you!

So what does all this mean to you?

There is an old axiom which states: "If one can be trusted with the 'small stuff,' how much more can that same individual be trusted with the 'big stuff.'"

It's the same philosophy we implement in the design and manufacture of all our products and equipment. We know and understand that even the most minute detail or inconsequential component could be the difference between tremendous success or catastrophic failure for our clients.

Take this "accessory mounting fixture," for example. To some, it might appear to be a non-critical component to the overall functionality of this piece of equipment.

To us, however, we know how much you depend on our attention to detail in providing appropriate durability in all aspects of our product design and extraordinary ruggedization where it matters most in our manufactured equipment.



It's just as simple as that.

Oh, sure, we could take some short-cuts to speed-up our engineering processes and production procedures, however, we would be falling short of not only our expectations but, more importantly, yours.

That's just not "who we are."

Who we are is a small group of highly specialized professionals with decades of theoretical and applied experience driven by our "pioneering spirit" to propel us to the forefront of our industry.

We're fiercely and adamantly determined to "do it better" than anyone else within our sphere of influence. Our work ethic and business approach may be "old-school," however, our products and services are "cutting-edge."

What you get is the "best of both worlds." We think you'll approve and enjoy your business experience with us - give us a call or drop us an email to savor the Reawakening of "Made in America."

[Click below for a Media Introduction to MCS....](#)

